

AVAILABLE FOR LEASE OR SALE LANDMARK BUILDING



1 North Main Street

4,882 SQFT

Ideal for:

- Banking
- Restaurants
- Retail
- Office
- Additional 2,000 SQFT Lower Level Space Available

Dating back to 1927 this majestic building has been the center place for the surrounding communities. Over the decades there has been many upgrades and has maintain a prestigious high level of quality. Ideal and move-in ready for a Bank, but can also accommodate a spectrum of uses including a restaurant, retail and office.

- Fully outfitted for a Bank operation with Drive-Thru & ATM service in place
- Meticulously & professionally maintained Landmark building in a highly visible location with predominant signage
- 24 off street parking spaces



FOR INFO CONTACT: MICHAEL BRIEHLER
609-394-7557 X 118
MICHAEL@SEGAL-LABATE.COM



AVAILABLE FOR LEASE OR SALE

4,882 SQFT

1 NORTH MAIN STREET, PENNINGTON, NJ

Unsurpassed Quality Inside & Out

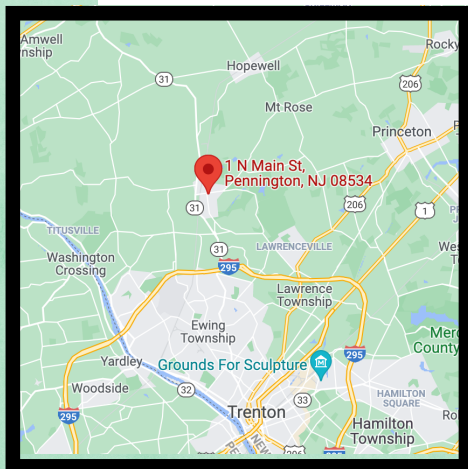
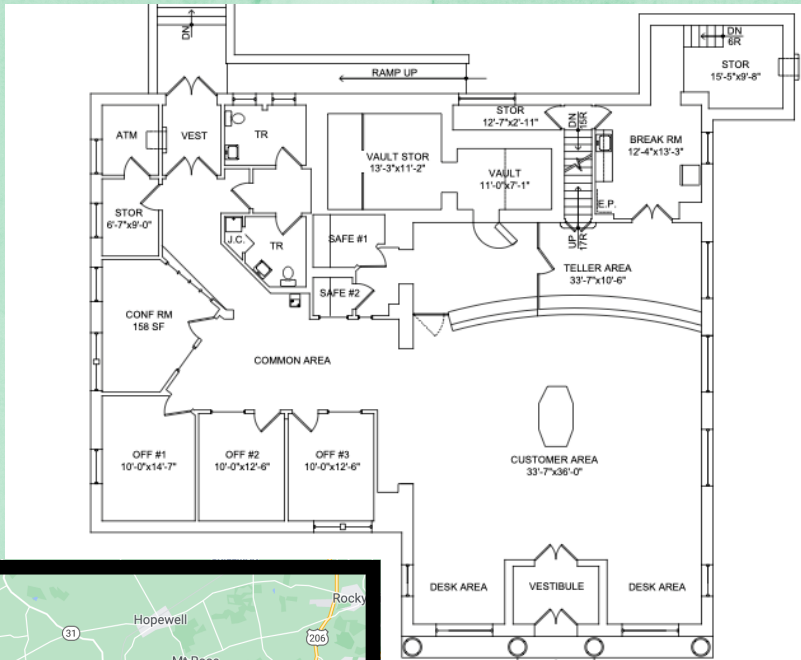

Location:

Conveniently located in the center of Pennington's charming, walkable business district serving the Hopewell Valley section of Mercer County with quick access to the Interstate highway network via Route 31.



Demographics	1 Mile	3 Mile	5 Mile
Population (2021)	3,638	13,378	53,987
Total Households	1,409	5,022	18,622

FOR INFO CONTACT: MICHAEL BRIEHLER
609-394-7557 X 118
MICHAEL@SEGAL-LABATE.COM

